

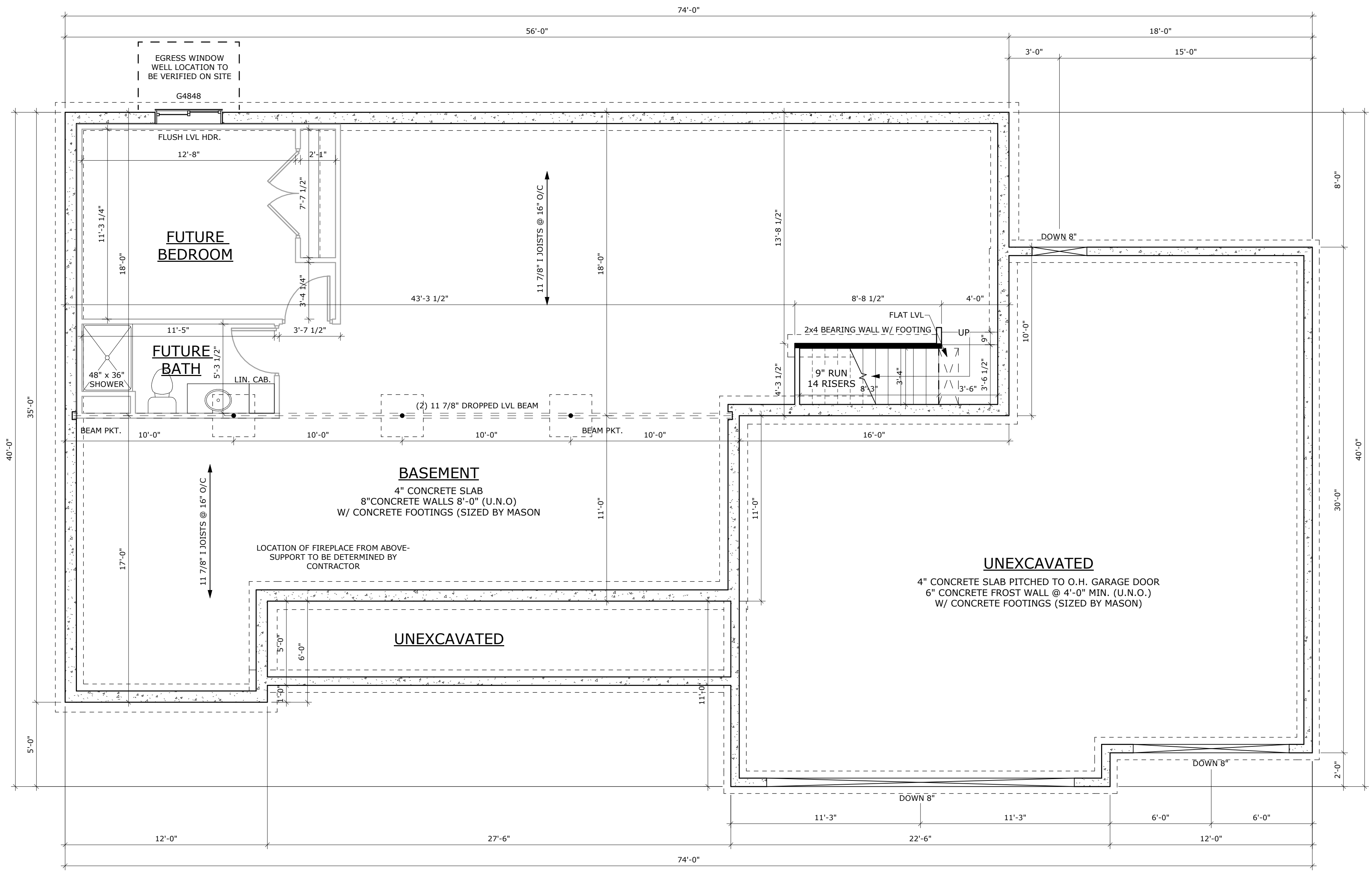

NEW HOME PLAN SPECIFICATIONS

- FOUNDATION INFORMATION**
- HOUSE FOUNDATION**
8" x 8'-0" POURED CONCRETE WALL
 - GARAGE FOUNDATION**
8" x 4'-0" POURED CONCRETE WALL
 - PORCH/PATIO FOUNDATION (UNEXCAVATED)**
6" x 4'-0" POURED CONCRETE WALL (MIN. 4'-0" TALL)
 - WALL THICKNESS FOR REPRESENTATION ONLY- MASON/CONTRACTOR TO VERIFY
 - FINAL WALL/POST FOOTING SIZE AND DEPTH DETERMINED BY CONTRACTOR
 - MASON TO LOCATE PILASTERS AND SIZE FOOTINGS PER CODE AND SOIL CONDITIONS
 - WINDOWS/DOORS TO BE SET IN CONCRETE WALL- MAKE R.O. 3" BIGGER IN WIDTH AND HEIGHT
 - BEARING WALLS TO SIT ON MIN. 16" X 8" CONT. CONCRETE FOOTINGS, STUDS @ 16" O.C.
- WALL INFORMATION**
- STUDS @ 16" O.C. (UNLESS NOTED/SHOWN OTHERWISE)
 - HOUSE EXTERIOR**
FIRST FLOOR WALL HEIGHT: 2 x 6 x 8' 1 1/8" (UNLESS NOTED/SHOWN OTHERWISE)
 - HOUSE INTERIOR**
FIRST FLOOR WALL HEIGHT: 2 x 4 x 8' 1 1/8" (UNLESS NOTED/SHOWN OTHERWISE)
 - GARAGE**
WALL HEIGHT: 2 x 4 x 9'-3 1/4" (UNLESS NOTED/SHOWN OTHERWISE)
- FLOOR SYSTEMS**
- BASEMENT**
4" CONCRETE SLAB
 - FIRST FLOOR**
11 7/8" I-JOIST @ 16" O.C.
STANDARD LOADING (PER SQ. FT.)
40' LL, 15' DL
ADDITIONAL LOADING (PER SQ. FT.) (WHEN APPLICABLE)
10' DL FOR TILE FLOOR
13' DL FOR GYPCRETE (1.5" THICK)
20' DL FOR FIREPLACE FACE/HEARTH
25' DL FOR GRANITE/QUARTZ
 - DEFLECTION: LL=L/480, TL=L/360
DURATION OF LOAD: 1.00%
- ROOF SYSTEMS**
- ENGINEERED WOOD TRUSSES @ 24" O.C.
DESIGNED FOR: ZONE 2
 - STD. LOADING (PER SQ. FT.)
30' TCL, 10' TCDL, 10' BCDL
 - DEFLECTION: LL=L/240, TL=L/180
 - DURATION OF LOAD: 1.15%
- HEADERS**
- STANDARD HEADER
 - ALL HEADERS NOT LABELED AS LVL TO BE MIN. (2) 2x10'S HEADER FOR ON-SITE (UNLESS VALUE ENGINEERED FOR OFF-SITE CONSTRUCTION)
 - TOP OF WINDOW R.O.S.
FIRST FLOOR @ 6'-11 3/8" ABOVE SUBFLOOR (UNLESS NOTED/SHOWN OTHERWISE)
 - MINIMUM OF (2) SHOULDER STUDS AT EACH END FOR ALL OPENINGS 6'-0" AND LARGER
- GENERAL INFORMATION**
- ALL DIMENSIONS ARE TO THE ROUGH STUD (UNLESS NOTED OTHERWISE)
 - 2X6 WALLS = 5 1/2", 2X4 WALLS = 3 1/2"
 - ALL DIMENSIONS ARE TO OUTSIDE OF FOUNDATION WALLS/BRICK LEDGES
 - GENERAL CONTRACTOR TO LOCATE THE FOLLOWING ITEMS IN THE FOUNDATION (WHEN APPLICABLE)
FLOOR DRAINS, ELECTRIC SERVICES, WATER HEATER, SUMP PIT + PUMP, FURNACE, GAS/LP LINE, BASEMENT, WINDOWS, ETC.
 - ACTUAL STEPS IN FOUNDATION WALLS AND LOCATION OF WINDOW WELLS TO BE DETERMINED ON-SITE BY GENERAL CONTRACTOR
 - DECK FRAMING SPECIFICATION TO MEET OR EXCEED REQUIREMENTS DEFINED WITHIN "APPENDIX B" OF THE WI UNIFORM DWELLING
 - ALL CABINET LAYOUTS ARE CONCEPTUAL-CONSULT CABINET DESIGNER FOR EXACT SIZES AND LOCATIONS OF CABINETS, APPLIANCES, AND WINDOWS
 - ALL DOOR HEIGHTS ARE 6'-8" UNLESS NOTED/SHOWN OTHERWISE

FIRST FLOOR AREA 1536 SF
TOTAL AREA **1536 SF**
 GARAGE FLOOR AREA = 908 SF



FOUNDATION PLAN
 1/4" = 1'-0"

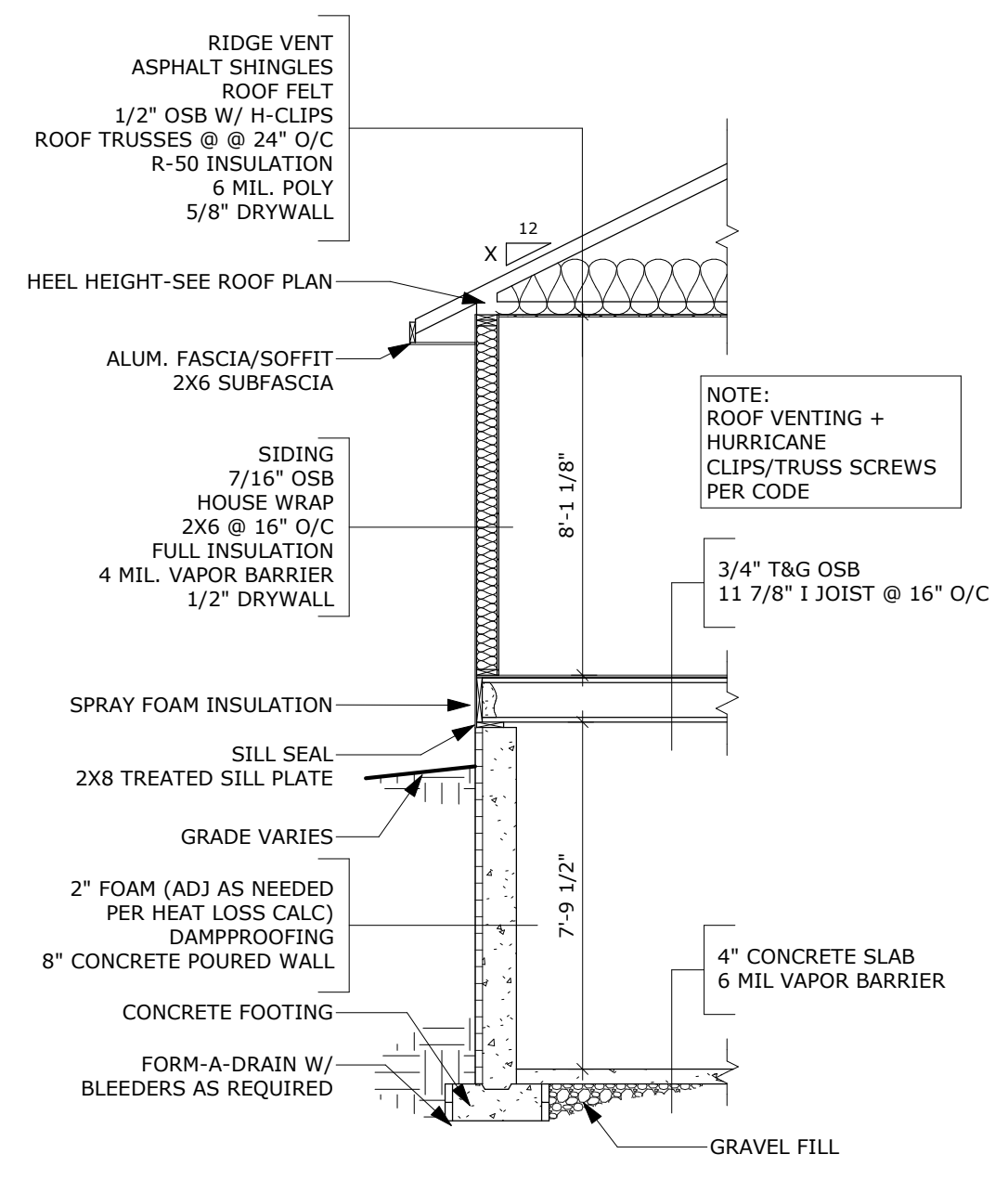

TYPICAL WALL SECTION
 1/4" = 1'-0"

FINAL PLAN

HEA	REV	DATE	DESCRIPTION
A	1	3/16/2024	ISSUED FOR PERMITS
A	2	3/22/2024	REVISED PER COMMENTS

COPYRIGHT © 2024
 CONSTRUCTION DOCUMENTS SHALL BE USED IN FULL AND IN ACCORDANCE WITH THE INTENT AND SCOPE OF THESE DOCUMENTS. ANY PARTIAL USE OR MODIFICATION OF THESE DOCUMENTS WITHOUT THE WRITTEN PERMISSION OF DREXEL TEAM SHALL BE AT THE USER'S SOLE RISK AND WITHOUT LIABILITY TO DREXEL TEAM. ALL RIGHTS RESERVED.

HR HOMES-2024-1

HR HOMES



DESIGNER: K. SOYK
 SCALE: 1/4" = 1'-0"
 SHEET NO: **A3**
 PROJECT NO: R24-167-C

LOT 5 HWY W PIPE